

EXPLOSION-PROOF UFO LED LIGHT

ATEX-II2G Ex db eb IIC T6Gb, II2D Ex tb IIIC T80°C

DESCRIPTION

The UBA series explosion-proof UFO LED lights is a Class I, Division 2 factory sealed LED light fixture for general illumination. These fixtures are built to perform effectively and economically in areas that may be difficult to service, expensive to shut down or any location requiring an increased degree of safety. Compared with conventional lighting, the UBA series LED consumes up to 85% less energy and typically lasts as long as 60,000 hours or more. Moreover, LED is available in various powers, offering a replacement option for existing 150W-400W MH or 500W-1000W HID fixtures.

CONSTRUCTION & MATERIALS

- ◆ High-duty die-casting aluminum alloy housing, fully sealed to be dirt and bug proof
- ◆ Impact-proof glass lens
- ◆ IP 66 rating waterproof protection
- ◆ Grey polyester powder-coated finish
- ◆ Taiwan Meanwell / Inventronic driver
- ◆ Stainless steel protective rope

EMERGENCY OPTION

- ◆ UL 924 & CEC title 20 compliant
- ◆ Charge time: 24 hrs
- ◆ Emergency time: 90~180 minutes
- ◆ Charge cycle: > 500 times
- ◆ Work Temp. -22°F ~ +122°F (-30°C ~ 50°C). Especial temperature will be consulted. *

MOUNTING AND WIRING

- ◆ Pendant mount/Conduit mount / Wall mount

ENVIRONMENTAL SYSTEM

- ◆ Where flammable vapors, gases, ignitable
- ◆ dusts, fibers or flyings are present;
- ◆ indoors or outdoors
- ◆ Where extremely corrosive, wet, dusty, hot and/or cold conditions exist

ELECTRICAL SYSTEM

- ◆ Input voltage 100-277VAC
- ◆ ATEX-II2G Ex db eb IIC T6 Gb, II2D Ex tb IIIC T80°C
- ◆ CNEX, CE, RoHS

OPTICAL SYSTEM

- ◆ 130 lm/w output efficacy
- ◆ CCT: 3000K, 4000K, 5000K, 5700K, 6500K.
- ◆ 120° beam angle

CORROSION PROOF GRADE

- ◆ Wf2

CABLE ENTRY

- ◆ NPT3/4, NPT 1/2

WARRANTY

- ◆ 5 Years

STANDARD

- ◆ CSA-C22.2 No. 250.13-12
- ◆ UL 8750, CSA-C22.2 No. 137-1981, UL 844
- ◆ Class 1, Division 2, Groups A, B, C and D; -50°C to +35°C
- ◆ Marine and wet locations, Type 4X, Ip66
- ◆ T6 temperature rating at 55°C

DATA SHEET

Model#	LT-UBA280B-30/50W-EP	LT-UBA280B-70/100W-EP	LT-UBA320B-120W-EP	LT-UBA320B-150W-EP	LT-UBA400B-200W-EP
Rated Power	30W/50W	70W/100W	120W	150W	200W
Output Efficacy	130 LPW	130 LPW	130 LPW	130 LPW	130 LPW
Input Voltage	100~277VAC	100~277VAC	100~277VAC	100~277VAC	100~277VAC
Beam Angle	120°	120°	120°	120°	120°
Driver	Meanwell	Meanwell	Meanwell	Meanwell	Meanwell
Waterproof	IP 66	IP 66	IP 66	IP 66	IP 66
Battery	20W/1.5 hrs	20W/1.5 hrs	20W/1.5 hrs	20W/1.5 hrs	30W-40W/1.5 hrs
Corrosion Proof	WF 2	WF 2	WF 2	WF 2	WF 2
Cable Entry	NPT3/4, NPT 1/2	NPT3/4, NPT 1/2	NPT3/4, NPT 1/2	NPT3/4, NPT 1/2	NPT3/4, NPT 1/2
L70 Life	>50,000hrs	>50,000hrs	>50,000hrs	>50,000hrs	>50,000hrs
Work Temp.	-30°C~50°C				
Certificate	ATEX-II2G Ex db eb IIC T6 Gb, II2D Ex tb IIIC T80°C				

ORDER INFORMATION

Sample Number: LT-UBA320B-150W-30K-EP/EM-STD.

Com.	Series	Code	Wattage	CCT	Voltage	Control Mode	Duration
LT	UBA	280B	30W	30K=3000K	Blank=100-277VAC DV= 24-48VDC	DM=0-10VDC Dim EM=Emergency Kit EP = Explosion Proof	Std.=90 Min. 2H =120 Min. 3H =180 Min.
			50W	40K=4000K			
		70W	50K=5000K				
		100W	57K=5700K				
		120W	65K=6500K				
320B	150W						
	400B	200W					
			240W				

Model #	LT-UBA-EP Series
Rating	ATEX-II2G Ex db eb IIC T6Gb, II2D Ex tb IIIC T80°C Db IP66
Version	A: 2021-01



DIMENSION

LT-UBA280B-30W/50W-EP



LT-UBA280B-70W/100W-EP

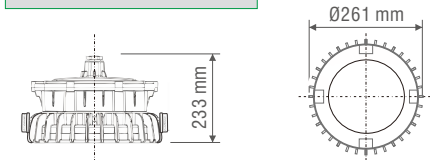

LT-UBA320B-120W/150W-EP

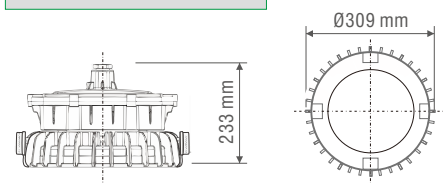

LT-UBA400B-200W-EP

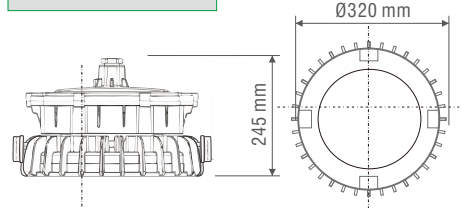

Model #	LT-UBA-EP Series
Rating	ATEX-II2G Ex db eb IIC T6Gb, II2D Ex tb IIIC T80°C Db IP66
Version	A: 2021-01

ACCESSORY

Model#	EXJB	EXCP	EXCT
Name	EX Terminal Junction Box	EX Connecting Pipe	EX Connector
Input Voltage	<380 VAC	—	—
Input Current	< 20 A	—	—
EX Mark	CNEX-ExdIICT6Gb/ExtDA21 IP65 T80°C	CNEX-ExdIICGb/ExtDA21 IP66	ExdII CGb/ExtDA21 IP66
Cable Entry	G 3/4" /M20-M25/NPT	G 3/4" /M20-M25/NPT	—
IP Rated	IP 66	IP 66	IP 66
ANTI-CORROSION GRADE	WF 2	WF2	WF2
Size	125x100x55 mm	700mm/1000mm/1500mm length	G 1/2",G 3/4",M20,M25
Material	Die-casting Aluminum	STAINLESS STEEL WIRE BRAIDING PVC	Carbon Steel
N.W.	0.5Kg		
Picture			

INSTALLATION

